

# The Southlands Transformation Fund

Transforming Lives  
Transforming Spaces



**Southlands College**

1872 150 years 2022

# An Enduring Vision

Southlands sustains its founding Methodist vision of offering excellent education for all within a supportive and formative community.

Founded in 1872, Southlands' original purpose was to educate women to become teachers in Methodist schools. John Wesley, the founder of Methodism, was deeply committed to education for social improvement and encouraged Methodists to found schools for children who otherwise had no access to formal learning. The college provided education of the highest standard and was shaped as a supportive and formative community. It offered a home from home to generations of young women as they studied how to offer life-changing education to children in

many of the poorest communities across the country.

Southlands remains a distinctive educational institution as one of the four colleges of the University of Roehampton. It looks very different and its staff and students represent far greater diversity, coming from all over the world to teach and study a variety of degree programmes. But they do this with the same mission of providing education for social change, equipping values-driven leaders who will change our world for the better.

The mission of Southlands College remains to transform lives through values-driven, high-quality education for people of all backgrounds.

As we celebrate 150<sup>th</sup> anniversary of the founding of Southlands College, we also look ahead to the future. Our anniversary presents us with an opportunity to define the next chapter in our story through our new Transformation Fund which rests on two areas: transforming lives and transforming spaces.

**Transforming Lives** is a bursary programme designed to remove financial barriers to education, with the specific goal of enabling access for the least economically advantaged in society.

**Transforming Spaces** is a major development project to re-shape Southlands College to be the very best learning environment for future generations of students.

Together, these two strands will equip us to offer the very best environment for the very best education. We invite you to read more about our community today and how you can support Southlands.





# Southlands at 150

Southlands is a thriving educational institution and a building block of a modern, world-class university.

Southlands is a centre for teaching and learning, research, and knowledge exchange. It is home to the Faculty of Business of Law, including its Centre for Sustainability and Ethical Business, Music Education, including its Applied Music Research Centre, and the Southlands Methodist Trust, including the Susanna Wesley Foundation.

Southlands is home to several co-curricular departments, including eSports and community music. It is also the base for a range of student support areas, including wellbeing, alumni, careers and student placements.

The Faculty of Business and Law draws on the college's distinctive nature to shape its own identity, including its taught programmes and its pedagogical approach. Its mission is to be a faculty with a social conscience, built on values of excellence, inclusivity, social responsibility and community. Programmes are designed to create responsible leaders, alert to the needs of a modern world and grounded in strong, community-centred values.

Business and Law is home to a large, diverse community of almost 3000 students with around half of those studying postgraduate programmes. Many of our students are those in greatest need of support while studying at university and those who tend to be disproportionately disadvantaged in society.





# Transforming Lives

Southlands, as part of the university, is making a difference but with your support we can do so much more.

Our graduates contribute much to society through their work as teachers and health workers, in the arts and sciences, and through their businesses as employers. We are seeking support from partners, alumni and friends of the college and the wider university community for our continuing mission to enable access to the excellent education on offer at Southlands.

A programme of bursaries will be established to improve access to education for people from economically disadvantaged backgrounds, supporting individuals with the living costs associated with studying at university. These might include basic needs, such as food and accommodation, but could also be the costs of family care, transport and learning resources.

Many of our students work more than one job to support themselves as they study. Transforming Lives bursaries are being formed specifically to offer financial aid to those struggling to sustain themselves during study because of the pressures of their personal circumstances and a lack of support network at home.

Potential donors are encouraged to contact us through the development office to discuss gifts to the Transforming Lives bursary programme. Those wishing to make a direct donation can do so by visiting **[giving.roehampton.ac.uk](https://giving.roehampton.ac.uk)** or by scanning the QR code above.





# Transforming Spaces

Shaping Southlands College for the next generation – a vision for a cutting-edge education space

We want to build – figuratively and literally – on the foundation of the past to shape an exciting and successful future.

The current college site was built in 1997. A huge amount has changed in the last 25 years in terms of the way we work, teach and learn. Our approaches to collaboration and community engagement have transformed, the working relationships between staff and students have radically altered, and our ambitions for community engagement have expanded.

Our plans to transform our spaces look to reshape the college, focusing on four principles:

**Education as community**

**Education as service**

**Education as formation**

**Education for sustainability**

## Reshaping the Queen's Building

The Queen's Building is the college's academic, co-curricular and student support hub. Our transformation goals include:

**Improved visual and physical connection to the immediate surroundings.**

**A greater variety of learning environments with the facilities to support modern teaching techniques and specialist training.**

**An enhanced identity, which supports and enables the academic disciplines housed at Southlands.**

**A range of creative and flexible spaces, which facilitate community-enhancing activities for our students, our staff and the wider Roehampton area.**





# Transforming Spaces

## Southlands Sidewalk and Southlands Welcome

A visually impactful development will see a plaza-style frontage from the campus onto Roehampton Lane, and a new pedestrian entrance into the college, offering access into spaces and university resources.

**Southlands Sidewalk** will provide an outward-facing 'shop front' for the college, an interface with local community and business.

**Southlands Welcome** will be a spacious, multi-functional area with various kinds of seating and spaces for the community to linger, look at art exhibitions, hold markets and networking events, and feel welcome.

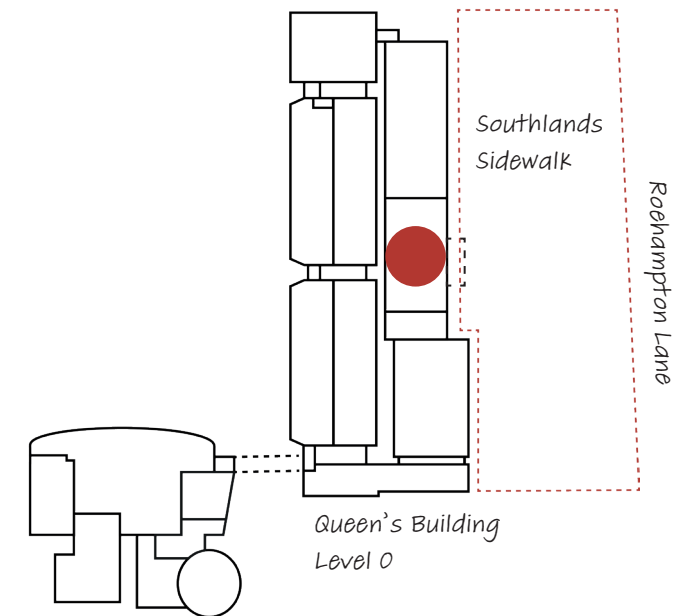
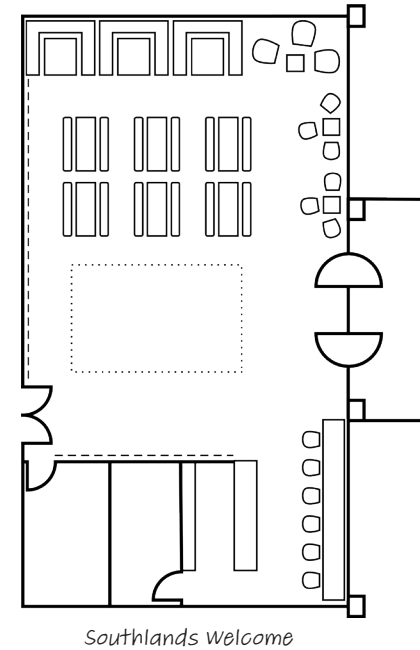



# Transforming Spaces

## Southlands Exchange

The Exchange will be the student and visitor go-to place in Southlands for accessing support and information. The goal is to place students at the heart of activity in the college, offering them an accessible place in a prime location. A long row of private offices will be demolished and turned into a bright, open area with a number of consultation rooms and open/semi-open settings for engaging with staff, along with self-help kiosks and seating.

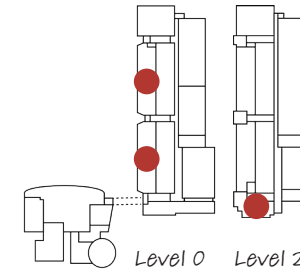
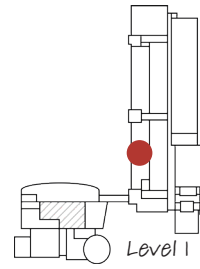
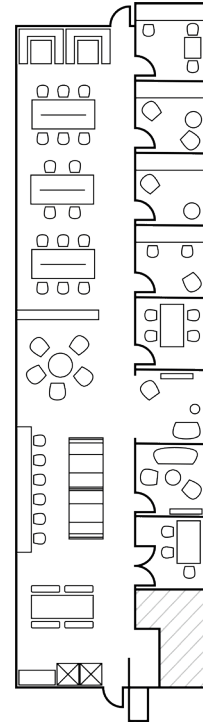

# Transforming Spaces

## Student Hubs

Two large student hubs and a lounge will be created, focused exclusively on student use across a range of study, co-curricular and social learning activities. A range of open settings with viewpoints will meet the needs of residential and commuting, postgraduate and undergraduate students.

These will include spaces to meet with other students, learn together, relax, eat and chat. There will be a number of rooms for quiet working and online learning, along with eSports and other online activities.

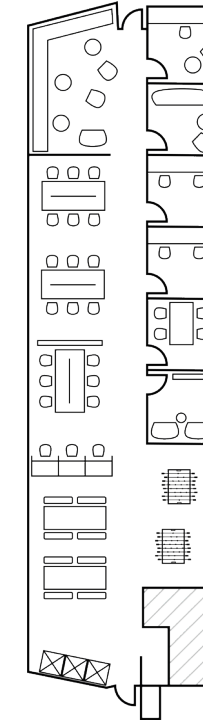



# Transforming Spaces

## Learning Mall, Learning Box and Learning Annexe

The traditional classrooms in the Queen's Building will be significantly restructured and upgraded to offer an enhanced, flexible learning experience. Improvements in both the spaces themselves and the resources they contain will make them the setting for cutting-edge learning experiences focused on the needs of our growing academic cohorts with an international reach.

Plans also include the creation of totally immersive, tech-rich spaces, a Bloomberg trading room, media studios and business labs.

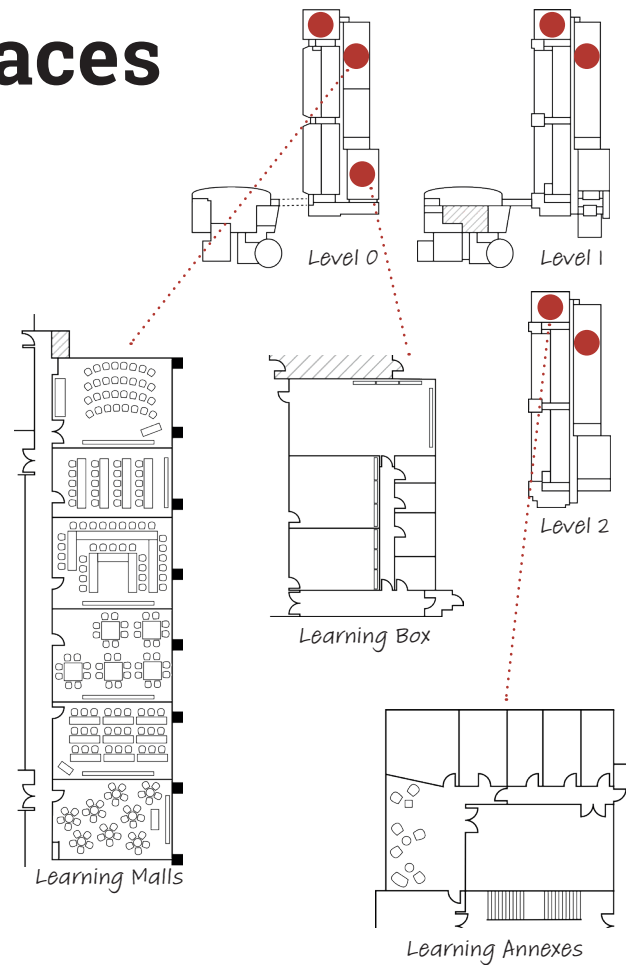

# Transforming Spaces

## Lakeside

Lakeside is the focus for community activity at Southlands, offering places to eat, drink, socialise, relax and pray. Plans will radically improve the area, especially to serve the needs of our growing community of commuting students. They are often in greatest need of support while studying at university and tend to be disproportionately disadvantaged in society.

The Senior Common Room will create a space for events ideal for showcasing the Faculty's research and knowledge exchange activity.

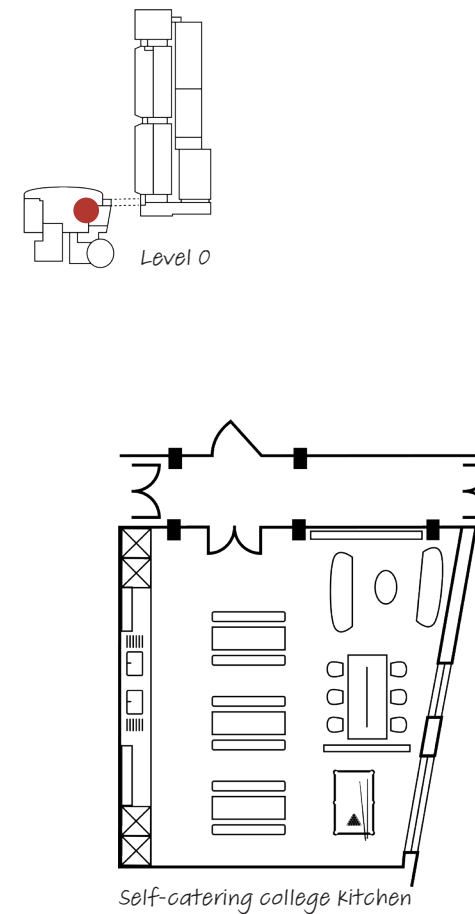



# Be Part of our Vision

The Transformation Fund is an ambitious project, supporting students and changing the environment in which they live and study.

In order to achieve our vision, we require support from like-minded individuals and organisations who share our values.

The capital project is an extensive £6.3m programme to transform the college space. The programme is phased over a minimum of five years as a number of separate, smaller projects.

Each of these projects works together to achieve our vision for Southlands, but can also be started and completed without relying on the others being achieved. That

way, we can begin our work to transform Southlands in stages, and as quickly as possible.

In order to move ahead, we are seeking to match the funding provided through university capital expenditure with support from corporate partnerships, trusts and foundations.

As modern and exciting spaces with high footfall, these new areas provide excellent opportunities for corporate sponsorship from organisations who share our aims

Gifts to the Fund will go directly to the project and make a tangible difference to what we can achieve in transforming the learning experience for our students.

and values. Funded or in-kind partnerships are an ideal route to building long-lasting relationships with the college, faculty and wider university. If you would like to explore how partnering with us can support your organisation's CSR aims, please contact Director of Development, Alumni and Careers, Eleanor Merrick, at [e.merrick@roehampton.ac.uk](mailto:e.merrick@roehampton.ac.uk) for an informal discussion.

Through our Transforming Lives programme we will create life-changing opportunities for our students, whether a

prize for entrepreneurship, a scholarship or hardship support. By supporting this Fund you will join our community of donors who are all making a difference for our students. Individual donations, planned giving or match-funded grants from organisations, no matter the size, will all have an impact.

Hayley was in her final year during the first wave of Covid19. She received help through the emergency hardship fund which was supported by many of our donors. She writes,

*"I am so grateful for the support that Roehampton has provided me with throughout my studies, especially in my final year when the pandemic started. I had to adapt to a new way of working and a new way of life at such a critical time in my academic journey. If it was not for the hardship fund and the study support offered to me, I would not have been able to finish my studies. My degree has helped me to grow in both personal and professional capacities. I am incredibly fortunate to be where I am today thanks to the support provided by this fund."*





# Southlands Transformation

All gifts help create opportunities for our students, whether a prize for entrepreneurship, a scholarship or financial support.

Individual donations can be made easily at [giving.roehampton.ac.uk](http://giving.roehampton.ac.uk) or by scanning the QR code.

We are also pleased to accept planned donations through legacies or in-memoriam giving. If you are interesting in leaving a legacy in your will or exploring this further, please email [alumni@roehampton.ac.uk](mailto:alumni@roehampton.ac.uk).



Join us as we build on the foundation stone of our unique heritage to create spaces and develop opportunities for future university students and the community that surrounds and supports them.

Christopher Stephens,  
Head of Southlands College



You still deliver on that historic vision as you 'serve the present age', offering life-transforming educational opportunity in a contemporary iteration of that same familial, supportive and intelligible setting. To this day people – particularly, but not only, young people – continue that Southlands tradition, finding opportunity, and challenging limitation and expectation, as they journey in their discovery of what life in all its fullness might mean for them.

Barbara Easton, Vice-President of the Methodist Conference and Southlands alumna, speaking in February 2022





[giving.roehampton.ac.uk](https://giving.roehampton.ac.uk)

[roehampton.ac.uk/Colleges/Southlands-College](https://roehampton.ac.uk/Colleges/Southlands-College)

[southlandsmethodisttrust.org.uk](https://southlandsmethodisttrust.org.uk)

